

European Solar and Energy Storage Solutions

How to install the bracket of solar floodlight



Overview

How do you install a flood light on a solar panel?

Plug the light sensor in the flood light, imitating daylight. Plug the flood light into the solar panel and secure in place by screwing on and fully tightening the cap. Experiment with desired position of both the flood light and solar panel, ensuring there is enough slack in the cable to safely.

How do I connect a floodlight bracket to a solar panel?

Connect the floodlight and solar panel cables (see below). Check the waterproof cable connector(s) are secure. Follow steps 4 and 5 above. Attach the relevant 76mm or 60mm brackets to both the floodlight bracket and solar panel bracket as per the instructions. Mount the bracket securely onto the column with the solar panel as high as possible.

How do you install a floodlight fixture?

It is recommended to use as much material as possible to secure any electrical wire connection. Now that the wires are connected, the rest of the installation process is quite easy; screw in the floodlight fixture to its mounting strap and then screw the light bulbs into their reserved locations.

How do I attach a black floodlight bracket?

Attach the black floodlight bracket to the floodlight using the 2x M8 hexagonal bolts, flat washers and lock washers (see diagram). Do not overtighten to allow adjustment after installation. 14mm spanner required.

How to install a solar panel bracket?

To install a solar panel bracket, apply adhesive to the upper side of the bracket (this is where the solar panel will be positioned). Position and press firmly the side bracket along the side of the solar panel and repeat this process with the other side bracket. Allow the adhesive to dry as per the product specifications.

How do I turn off a flood light?

Remote control can command more than one fitting in range. Infra-red sensor is located in the flood light lens. For first time use, select the AUTO function. To turn off permanently / enter sleep mode, hold down the off button for 5 seconds (the light will turn off, flash on twice and then turn off permanently).

How to install the bracket of solar floodlight



Solar Street Lights Outdoor Lamp, 16000lm IP67 Waterproof Light ...

Solar Flood Lights Outdoor, 10000LM 6500K Motion Sensor Outdoor Lights Dusk to Dawn, IP65 Solar Street Lights Outdoor Waterproof with Remote Control, Outdoor Solar Lights for Yard, ...

How To Install Outdoor Flood Lights , Storables

The secure attachment provided by the mounting bracket sets the stage for the next phase of the installation, which involves connecting the wiring and affixing the flood light fixtures. With the mounting bracket in place, ...



Enlightening Pathways: A Step-by-Step Guide to Installing Solar ...

Pole Mounting: Attach the solar flood light to the mounting bracket on the pole. Make sure it's securely fastened. Ground Installation: Position the solar flood light on the marked area and ...



How To Install a Garage Floodlight

Before starting installation, you'll need to choose

the best location for the floodlight and prepare the mounting surface. Selecting the Optimal Location. Consider these factors when choosing where to install your ...



The 9 Best Solar Flood Lights of 2024, From My Hands ...

The best solar flood lights offer a measure of security and outdoor illumination. and it comes with a metal pole and a bracket. With a minimum of 6 hours of direct sunlight, this dusk-to-dawn

A Step-by-Step Guide to Installing Floodlight Cam E340

Install the Mounting Bracket o Run the existing wires through the hole of the junction box. o Hold the mounting bracket onto the junction box, align the screw holes, remove the foam from the ...

SUPPORT REAL-TIME ONLINE MONITORING OF SYSTEM STATUS



How To Install a Solar Sensor Light

3 ???· We'll show you how to install the light and the solar panel in just a few steps. Steps. 1 Position the light. First, figure out the best position for your light and solar panel. 2 Remove the mounting bracket. Take the mounting bracket ...

How To Install a Solar Sensor Light

3 ???· We'll show you how to install the light and the solar panel in just a few steps. Steps. 1 Position the light. First, figure out the best position for your light and solar panel. 2 Remove the ...

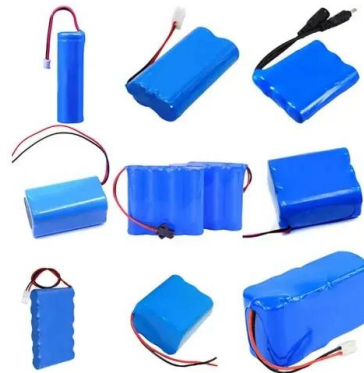

USER MANUAL LUMELUX Solar Flood Light (Remote Control)

Experiment with desired position of both the flood light and solar panel, ensuring there is enough slack in the cable to safely hook up when they are mounted in the desired location. 3. Once ...

A Step-By-Step Guide To Installing Solar Flood Lights

Another option is the solar flood light with a clamp or bracket. These lights are equipped with a clamp or bracket that can be attached to a variety of surfaces, such as fences, decks, or even trees. The clamp or ...



How To Put Solar Lights On Fence Post: 7 Easy Steps

Begin by measuring the post and cutting the light's mounting bracket to fit. Next, attach the bracket to the post using screws, ensuring that the solar panel is facing in the direction of total sun exposure. Cut and Strip the ...



A Step-by-Step Guide to Installing Floodlight Cam ...

Install the Mounting Bracket
 o Run the existing wires through the hole of the junction box.
 o Hold the mounting bracket onto the junction box, align the screw holes, remove the foam from the holes, then secure the mounting bracket on ...

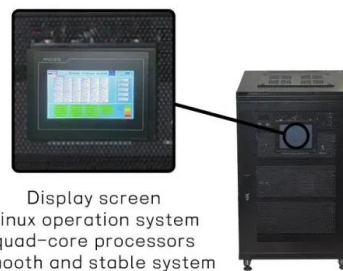

Setting Up and Installing your Ring Smart Lighting Solar Floodlight

Setting Up and Installing your Ring Smart Lighting Solar Floodlight. Setting up your Smart Lighting Solar Floodlight in the Ring app is simple. Simply scroll down for a step-by-step guide. Step ...

Setting Up and Installing your Ring Smart Lighting Solar Floodlight

Select an install location within 13 feet of your Floodlight that can get direct sunlight. Mark the holes using the mounting arm as a template then drive the two mounting screws. If installing ...



A Step-by-Step Guide to Installing SoloCam S340

4. Install the mounting bracket of the solar panel in a suitable position. 5. Install the solar panel onto its mounting bracket by turning it, then adjust the angle (20° ~ 30° recommended).
Option ...

Contact Us

For catalog requests, pricing, or partnerships, please visit:
<https://ssab-proiect.eu>