

## European Solar and Energy Storage Solutions

# Power generation of 3 square meters of solar panels



## Overview

---

Solar panels are rated by the amount of power they can produce in ideal conditions, typically around 1,000 watts per square meter.

Solar panels are rated by the amount of power they can produce in ideal conditions, typically around 1,000 watts per square meter.

Solar panel watts per square meter (W/m) measures the power output of a solar panel based on its size. Compare solar panels to see which generates most electricity per square meter. A higher W/m value means a solar panel produces more power from a given area.

Solar Power Per Square Meter Calculator. The amount of solar intensity received by the solar panels is measured in terms of square per meter. The sunlight received per square meter is termed solar irradiance.

How to Calculate Solar Panel kWh: To find the power in kWh, consider panel size, efficiency, and the output per square meter of panels.

Solar panel output per day. It is usually measured in kilowatt-hours (kWh). To estimate the potential electricity that your solar panels would generate per day, you can use the following formula: Size of one solar panel (in square meters) x 1,000; That figure x Efficiency of one solar panel (percentage as a decimal)

## Power generation of 3 square meters of solar panels

---



### How Many Solar Panels Do I Need To Power a House?

The goal of most solar projects is to offset your electric bill 100%, so your solar system is sized to fit your average electricity use. Here's a basic equation you can use to get an estimate of how many solar panels you ...

### How Much Energy Does Solar Panels Produce per Square Meter

Since each residential home has around a minimum of 263.25 per sq foot or 24.45 square meters of solar panels installed, this equals at least 3.95 Kilowatts of total energy per sq foot or 3.67 ...



### Guidelines for the dimensions of solar panels

Below, we will compare low-power solar panels (330W) with high-power solar panels (490W) to understand the rooftop space occupied by photovoltaic arrays: 330W solar panel size: 1855 \* 1092 \* 40mm. 490W solar ...

### How Much Energy Does Solar Panels Produce per ...

Since each residential home has around a

minimum of 263.25 per sq foot or 24.45 square meters of solar panels installed, this equals at least 3.95 Kilowatts of total energy per sq foot or 3.67 Kilowatts of total energy per sq meter.



## Understanding Electric Meters for Solar Panels , Paradise Energy

Why Your Utility Meter Should Also be a Net Meter or Smart Meter. Most solar systems are not independent of the utility grid. These systems are called grid-tied systems, and combine the ...

## How does the land use of different electricity sources compare?

One part of the total land use is the space that a power plant takes up: the area of a coal power plant, or the land covered by solar panels. Their land use is given in square ...



## What is a Solar Power Meter and How does it work?

A solar power meter is a device that measures solar power or sunlight in units of W/m<sup>2</sup>, either through windows to verify their efficiency or when installing solar power devices. Solar meters accumulate PV yield production ...

## Solar Panel Cost in 2024: How to Estimate The Cost of Solar , Solar...

Utility-scale solar installations are now cheaper than all other forms of power generation in many parts of the world and will continue to replace older, dirtier power plants that run on coal and ...



## Mars Surface Power Generation Challenges and Considerations

Reduced Solar Energy Availability Solar energy has long been the reliable choice for in-space power applications, but solar array designs on Mars must account for reduced solar flux, which ...

## How to Understand Solar Panel Watts Per Square Meter

The higher the watts per meter square, the more power a solar panel can generate from a given area. It might help you decide how many solar panels you need. Significance of Watts per Square Meter in Solar Panels. ...



## Solar Panel Sizes and Wattage Explained

While it takes roughly 17 (400-watt) panels to power a home. Depending on solar exposure and energy demand, the number of panels can also range from 13 to 19. It's often seen that larger homes might require more solar ...



## Solar Power Per Square Meter Calculator

How many square meters of solar panels do you need? Try our solar panel cost calculator if you want to work out what size of solar system you need to save money whilst being grid-tied. We've also written in more detail ...

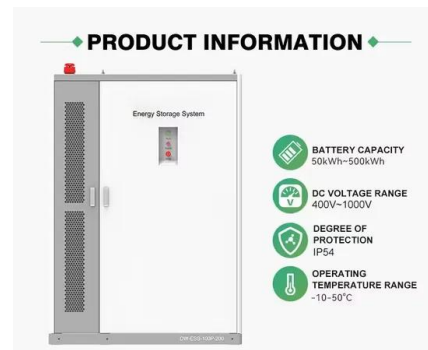

## Solar Panel Watts Per Square Meter Explained

Solar panel watts per square meter (W/m) measures the power output of a solar panel based on its size. Compare solar panels to see which generates most electricity per square meter. A higher W/m value means a solar panel ...

## Contact Us

For catalog requests, pricing, or partnerships, please visit:  
<https://ssab-proiect.eu>