

European Solar and Energy Storage Solutions

What is the size of the slide rail for photovoltaic panels

Utility-Scale ESS solutions



Overview

To estimate total rail size, simply multiply the module width (if in portrait, or the module length if in landscape) by the number of modules in a row.

To estimate total rail size, simply multiply the module width (if in portrait, or the module length if in landscape) by the number of modules in a row.

To estimate total rail size, simply multiply the module width (if in portrait, or the module length if in landscape) by the number of modules in a row. Then add one inch between each module and two inches at each end of the modules for the mid and end clamps, respectively.

Once you've determined how many panels your site can handle, and the rails necessary to hold the panels, the last step is choosing the clamps that secure the modules to the frame. Most modules are between 1.00" - 2.00" thick.

Solar panel mounting rails and racks are structural elements designed to secure solar panels in place. They ensure proper alignment, maximize exposure to sunlight, and provide stability against environmental factors like wind and snow. Common types include roof mounts, ground mounts, and pole mounts, each suited to different installation needs.

QRails® come in three lengths – 168 inches (14 ft), 183in (15.25ft), and 208 inches (17.3 ft) – and in two finishes: mill and black. Designed for strength and versatility. Modules can be mounted in portrait or landscape orientation in either standard or shared rail configurations. What are solar aluminum rails?

Understanding Solar Aluminum Rails Solar aluminum rails, also known as solar mounts or frames, are the structural support for solar panels. They hold the panels securely in place, allowing them to absorb sunlight efficiently. These rails must be strong enough to withstand harsh weather conditions while also being lightweight for easy installation.

What should a solar panel rail look like?

Structural Integrity: Rails should have a secure and stable design, able to

withstand wind loads and other external forces without bending or warping. Compatibility: Ensure that the rails are compatible with your specific solar panels and the overall photovoltaic system.

How do I choose a solar panel rail?

Compatibility: Ensure that the rails are compatible with your specific solar panels and the overall photovoltaic system. Ease of Installation: Choose rails that are designed for quick and easy installation. This saves time and labor costs, crucial factors in any construction project.

What are solar panel mounting rails & racks?

Solar panel mounting rails and racks are structural elements designed to secure solar panels in place. They ensure proper alignment, maximize exposure to sunlight, and provide stability against environmental factors like wind and snow. Common types include roof mounts, ground mounts, and pole mounts, each suited to different installation needs.

What is the difference between railed and shared rail solar panels?

This type of mounting system works the same as the railed system. The difference lies in the number of rails needed to be installed. While railed systems for two solar panels row use four rails in total, shared-rail systems use only three rails — by using two rails on the edges and one in the middle that shares the two rows.

What size solar mounting rails do I Need?

Solar mounting rails come in various sizes to accommodate different panel dimensions. The standard length is 4200 mm, which suits four units of 990 mm-996 mm width PV modules. However, customized lengths can range from 50 cm to 600 cm, allowing flexibility for various installation projects.

What is the size of the slide rail for photovoltaic panels



Choosing The Best Solar Panel Racking System

This can lead to accidents and even injuries. In addition, if you are installing solar PV systems in areas with severe weather, it is also essential to ensure the solar panel racking system can handle these extreme conditions. ...

Solar Rail Splice Buying Guide: Your Key to Efficient Solar Panel

At the heart of every solar panel installation lies the solar rail splice, a crucial component that ensures the stability and efficiency of the entire system. SIC Solar, a leading ...



Solar Panel Dimensions and Sizes: Complete Guide

60-Cell Solar Panels. The standard solar panel size, the 60-cell is structured as a 6x10 grid and measures 3.25 feet by 5.5 feet. 72-Cell Solar Panels. The average 72-cell solar panel size ...



Solar Panel Mounting Systems and Their Installation

While railed systems for two solar panels row use

four rails in total, shared-rail systems use only three rails -- by using two rails on the edges and one in the middle that shares the two rows. Solar panel installation costs ...



A guide to mounting racks for solar panels (PV)

In the solar market there are five basic types of mounting structures of which four are fixed-angle types (a-d) and one variable-angle type (e): a) roof mounted racks. b) ground mounted racks. c) top-of-pole mounted racks. d) side-of-pole ...

QRail® System

Simply insert QSplice® into the rail and slide the other rail on to create a fully structural, bonded splice. Size of module array: Any size possible*
 Position of the module array: structural performance of roof attachments for above roof
 ...

Commercial and Industrial ESS

Air Cooling / Liquid Cooling

- Budget Friendly Solution
- Renewable Energy Integration
- Modular Design for Flexible Expansion



Solar PV Racking Options

Solar PV Racking Options - Comparison Chart. Racking and mounting can often be the most complicated portion of a solar PV system installation. The racking is the foundation of the system - it protects the modules, the roof and people ...

Photovoltaic profiles: rails and supports for fixing ...

That is why at Sun-Age we specialise in the design and production of photovoltaic profiles, rails, Aluminium supports for photovoltaic panels, SIZE P100S02-32 3.20mt P100S02-64 6.40mt DATA SHEET. P100S03 ZINC MAGNESIUM ...



Mounting Solar Modules and Estimating Parts

To estimate total rail size, simply multiply the module width (if in portrait, or the module length if in landscape) by the number of modules in a row. Then add one inch between each module and two inches at each end of the modules for the ...

Solar Racking Made Simple: What You Need to Know About

Installing a solar energy system can be a challenging task. A home solar panel installation will include up to or more than a thousand parts so gathering the right component parts can take a ...



Guide to Solar Panel Sizes & Dimensions (November ...

If the solar panel system size you would like requires too many solar panels and thus, too much roof space, try opting for a larger solar panel size. Our table accounts for calculations with 250W panels.

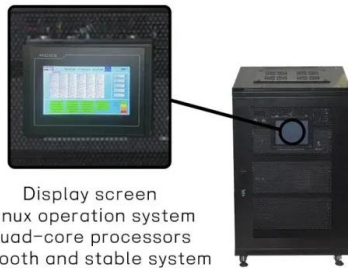

Display screen
Linux operation system
quad-core processors
smooth and stable system

How to Install a Rail-less Solar Panel System: A Step-by-Step Guide

What is a Rail-less Solar Panel System? A rail-less solar panel system eliminates the need for traditional mounting rails. Instead, the panels are attached directly to the roof using specialized ...

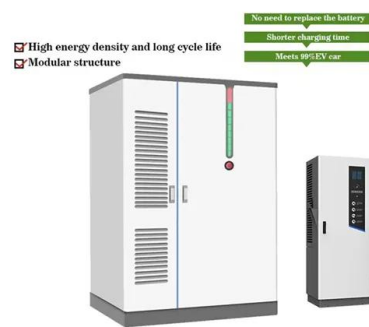

Solar Panel Mounting Rails: From Ground to Roof Mounted

What Are Solar Panel Mounting Rails? Solar panel mounting rails are integral components in solar panel installations, serving as the foundation framework that guarantees the solar panels ...



Contact Us

For catalog requests, pricing, or partnerships, please visit:
<https://ssab-proiect.eu>